BHDP



Cincinnati State
TECHNICAL AND COMMUNITY COLLEGE
Clifton Campus Master Plan
December 11, 2023

Site Plan | Existing



VISION STATEMENT

Our campus master plan will provide a strategic and visionary roadmap to transform the physical environment into a vibrant, efficient, and student-friendly collegiate campus by engaging people with spaces that are highly accessible, and intuitive, and provide a place of belonging where one can embrace new academic programs and technologies.

COLLEGIATE

Feels Like A College, Collegiate, A Place Of Belonging, Student Spaces, Student-friendly, A Home For Transfer Students

VIBRANT

Modern, Contemporary, Highlights Excellent Tech Programs, Advanced Technology

ENGAGING

Welcoming, Accessible, Wayfinding, Affordable, Engaging, Intuitive Design

EFFICIENT

Flexible, Green, Economical, Fluid

GROWTH

Academic Programs, Workforce Development

DESIGN DRIVERS

CHALLENGES & OPPORTUNITIES

KEY ISSUES

WAYFINDING
SENSE OF PLACE
DIVISIONS' ORGANIZATION
SOFT SPACES
LAB EQUIPMENT
DEFERRED MAINTENANCE

Planning Strategies

CLARITY OF CIRCULATION
GREENSPACES | CONNECTIONS
REINFORCE IDENTITY
ACTIVATE SPACE-IN-BETWEEN
INCREMENTAL
PRIORITIZED

EXISTING FLOOR PLANS

- Business Technologies
- Engineering and IT
- Health and Public Safety
- Humanities and Sciences
- Classroom and Computer lab
- Student Life
- Vertical Circulation
- Building Support
- Administration
- Student Services
- Unused



Level 4

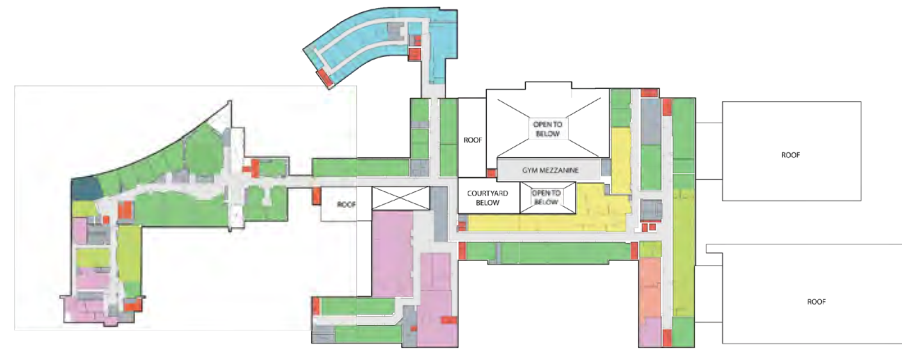

Level 3

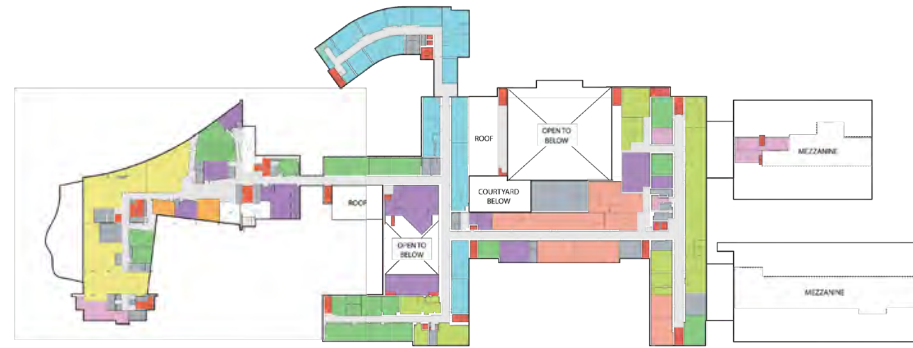

Level 2

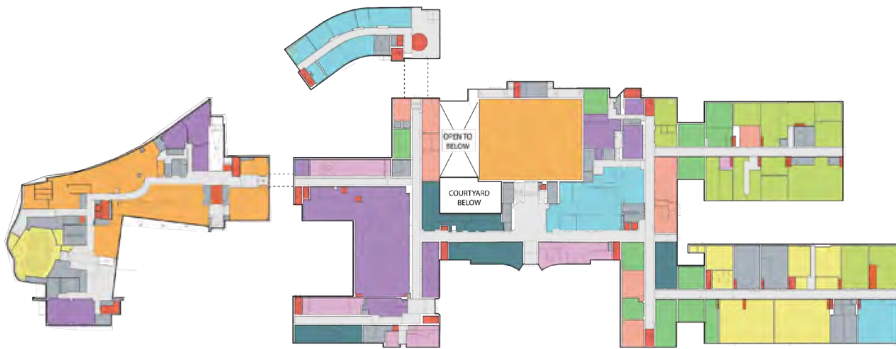

Level 1

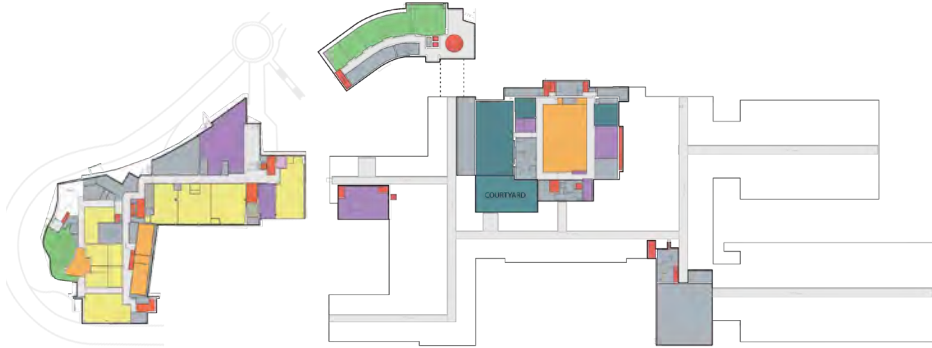

Level 0

DESIGN DRIVERS



EFFICIENT

GROWTH

COLLEGIATE

VIBRANT

ENGAGING

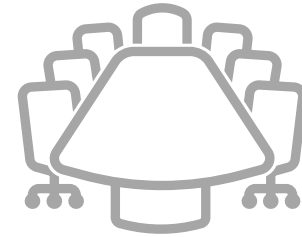
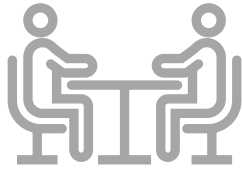

CLASSROOM NEEDS FROM INSTRUCTIONAL SPACE ANALYSIS REPORT

• Existing Classrooms	64
• Best Fit Classrooms	41
• Classrooms in Master Plan	48

ALL COLLEGE CLASSROOMS

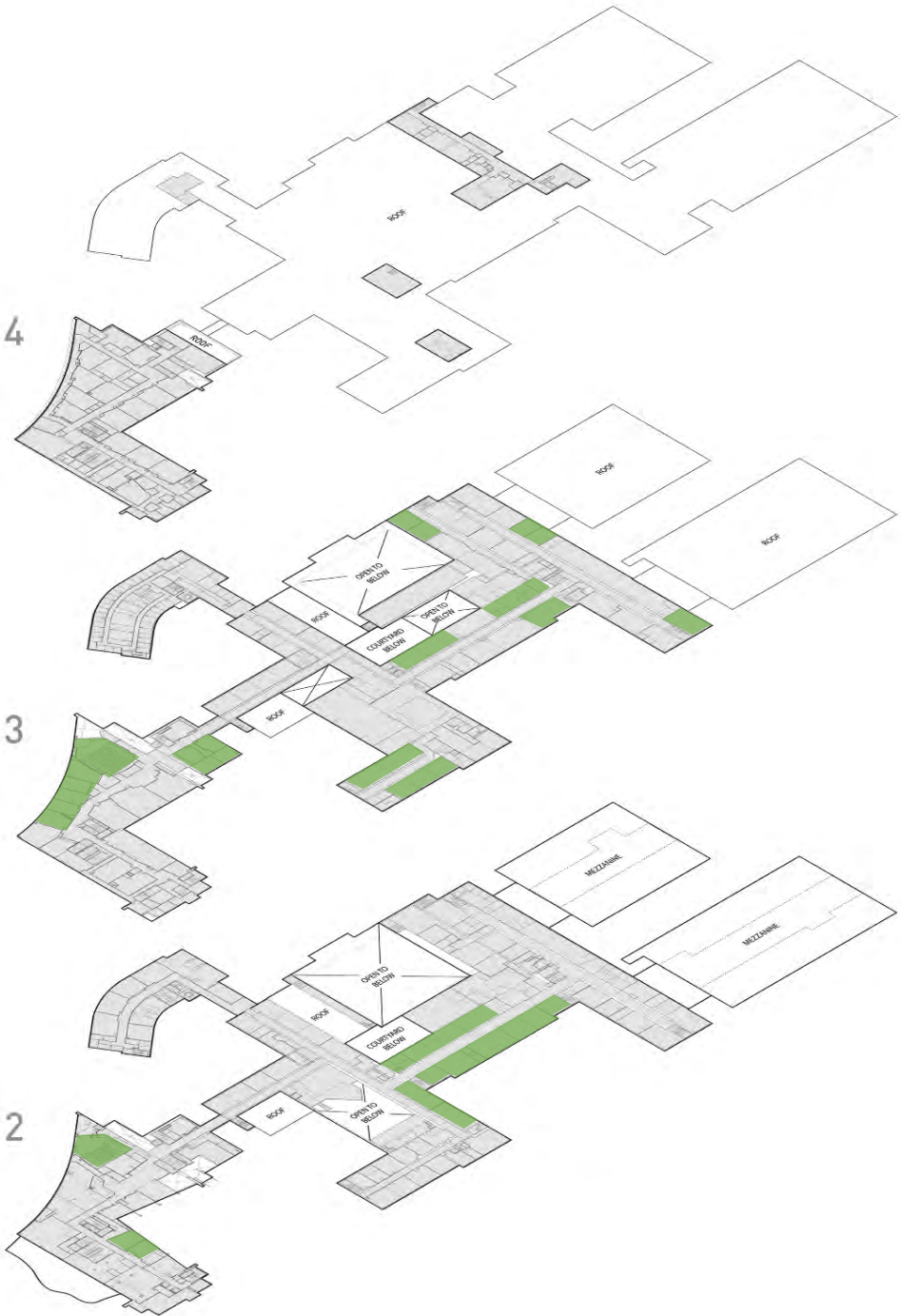
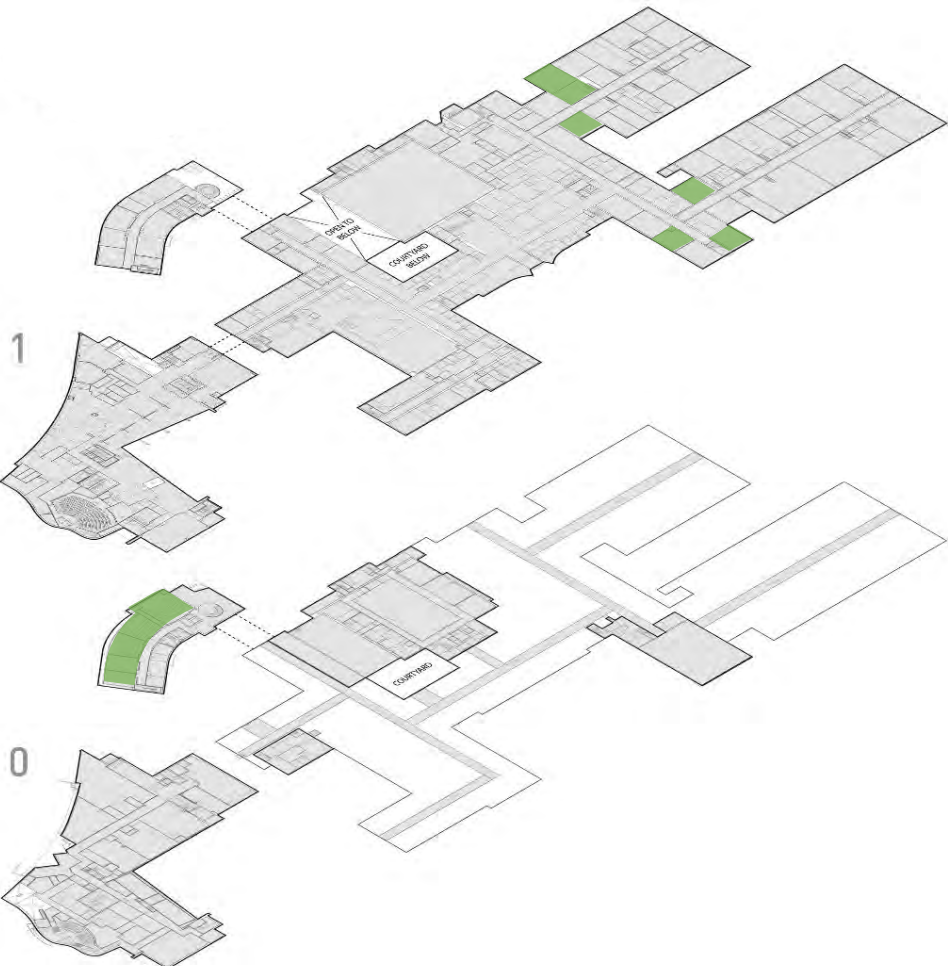

EXISTING FACULTY SUITES

- Business Technologies
- Engineering and IT
- Health and Public Safety
- Humanities and Sciences
- Classroom and Computer lab
- Student Life
- Vertical Circulation
- Building Support
- Administration
- Student Services
- Unused

Level 3



Level 2



PROPOSED FACULTY SUITES

- Business Technologies
- Engineering and IT
- Health and Public Safety
- Humanities and Sciences
- Classroom and Computer lab
- Student Life
- Vertical Circulation
- Building Support
- Administration
- Student Services
- Unused



Level 2

FACULTY SUITE AXON DIAGRAM

- CONFERENCE ROOM
- BREAKOUT SPACE
- ADJUNCT FACULTY TOUCHDOWN
- TYP. OFFICE
- COPY ROOM
- STORAGE

- STUDENT FACULTY MEETING ROOM
- ACADEMIC ADVISING
- SECURE DOOR
- RECEPTION
- MAIN ENTRY
- STUDENT WAITING AREA

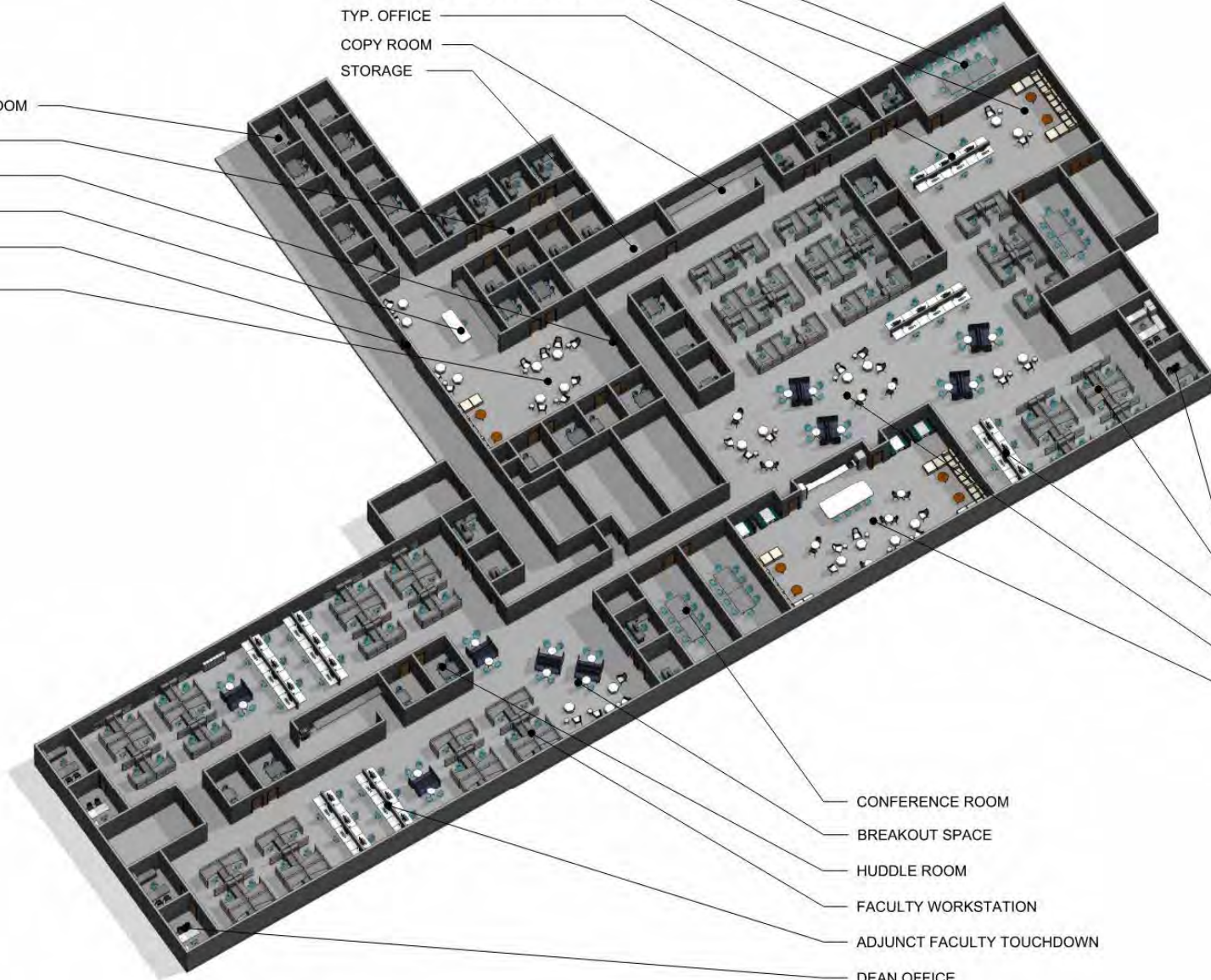

- TYP. DEAN OFFICE
- FACULTY WORKSTATIONS
- ADJUNCT FACULTY TOUCHDOWN
- BREAKOUT SPACE
- FACULTY BREAK ROOM

- CONFERENCE ROOM
- BREAKOUT SPACE
- Huddle ROOM
- FACULTY WORKSTATION
- ADJUNCT FACULTY TOUCHDOWN
- DEAN OFFICE

FACULTY OFFICE PRECEDENT IMAGES



LAB GROWTH

Business Technologies

- Lab Support Classrooms
- Potential Business Expansion

Engineering and IT

- Wastewater Lab
- Environmental Lab
- Potential E+IT Expansion

Humanities and Sciences

- Physics Labs
- Chemistry Labs

Health and Public Safety

- Allied Health Expansion
- Nursing Labs
- EMS Lab

LAB GROWTH

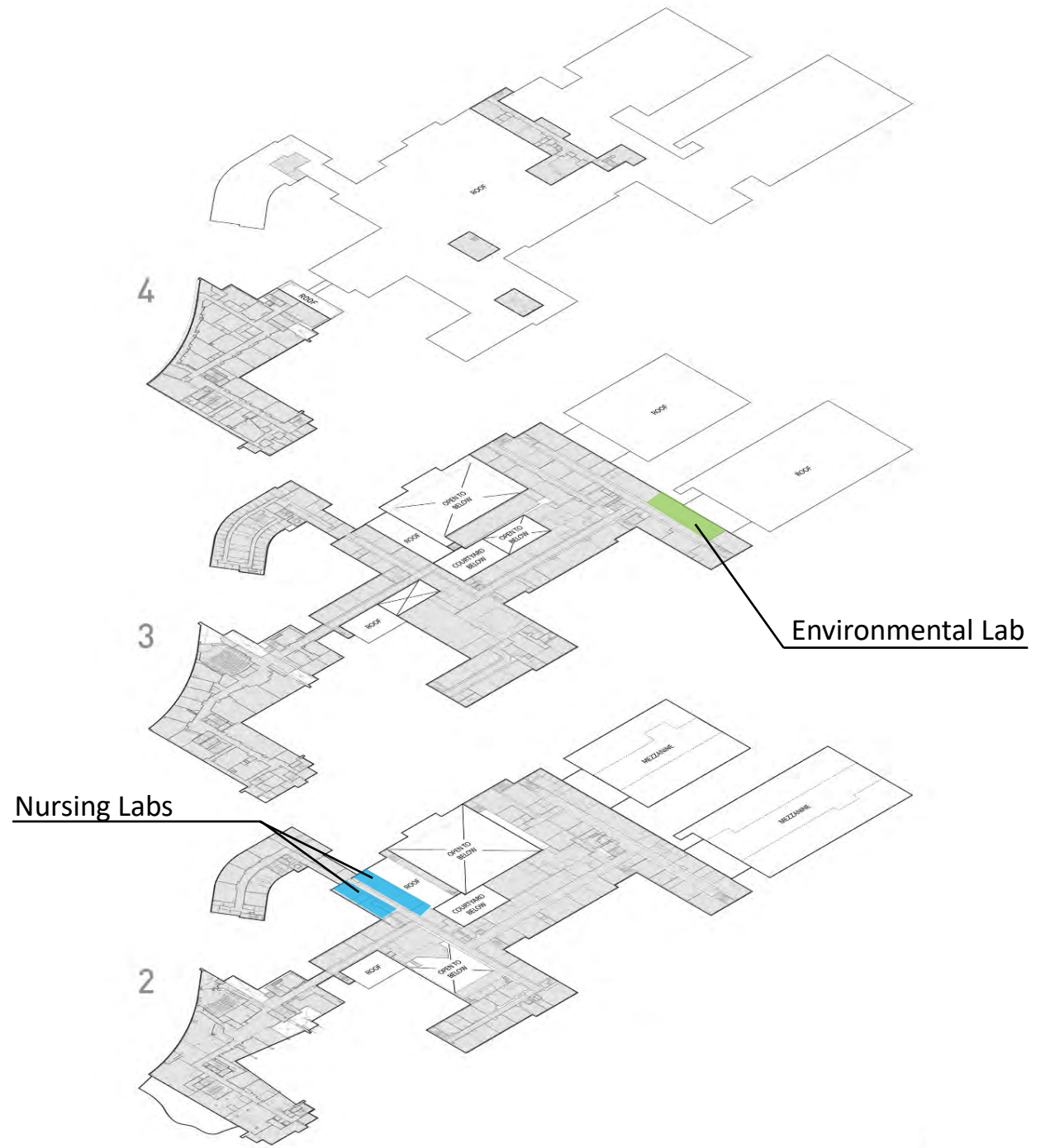
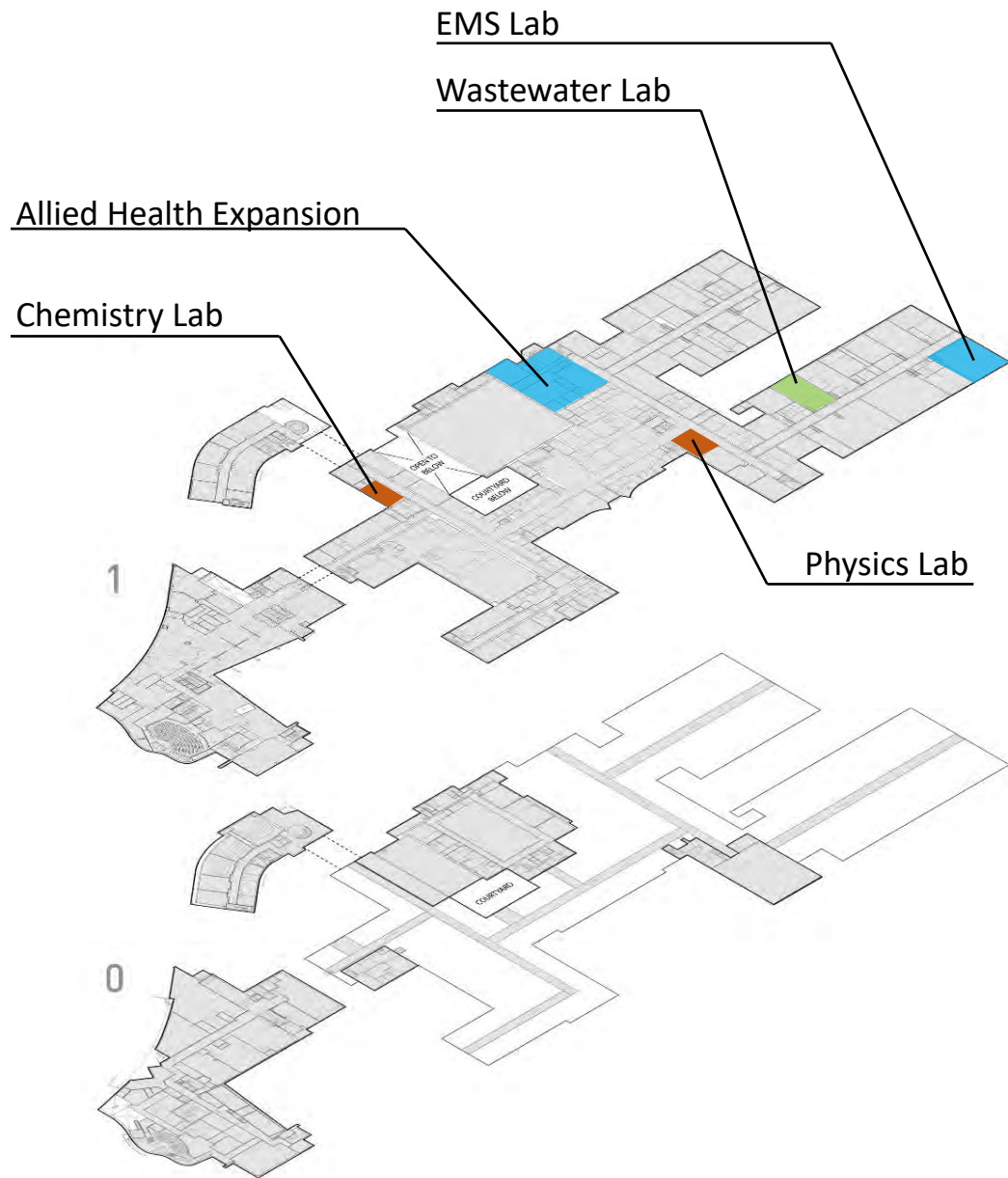

Site Plan I Strategies

1. South Entrance Drop-Off

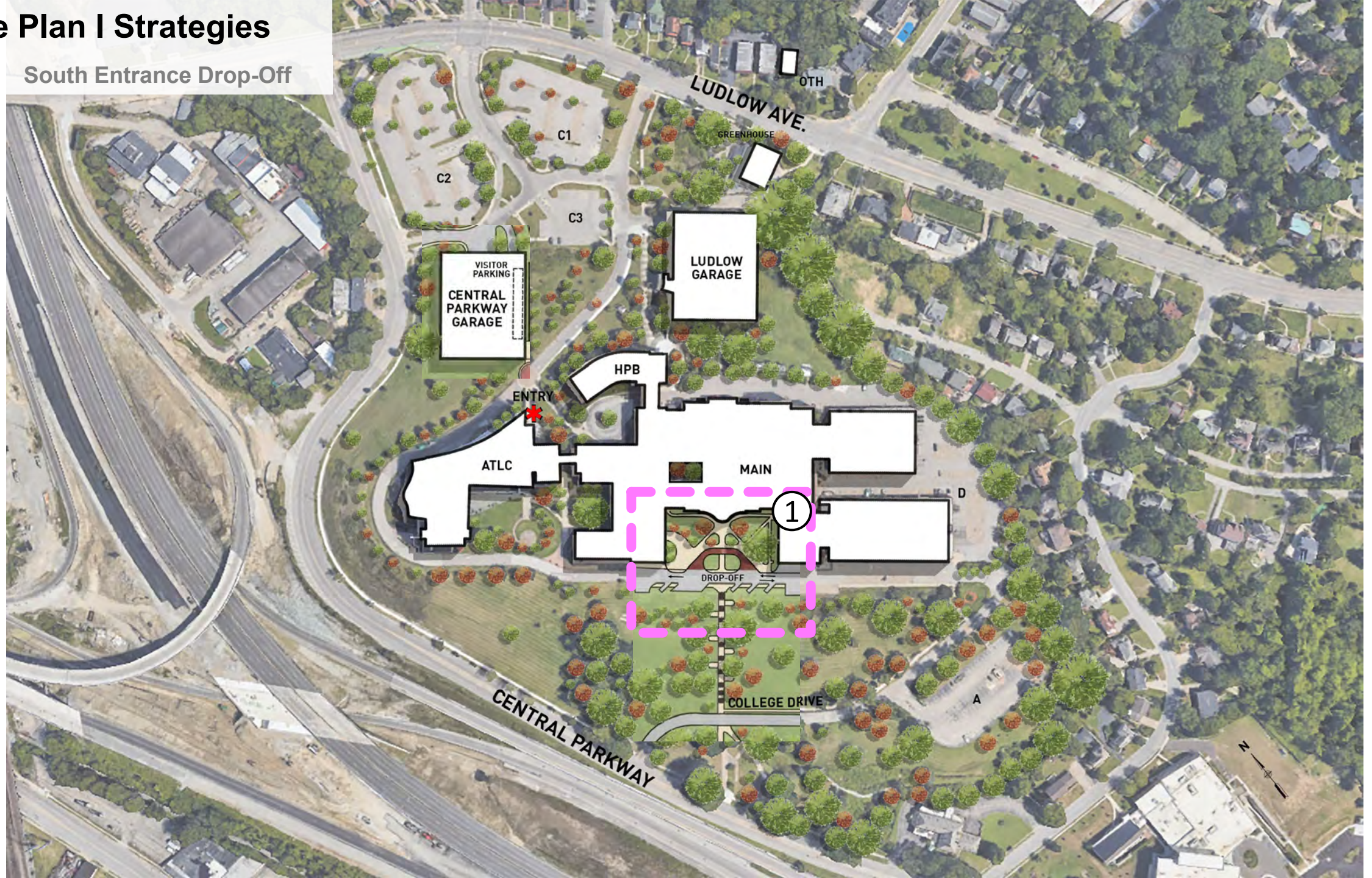

Site Plan I Proposed South Entry Drop-off

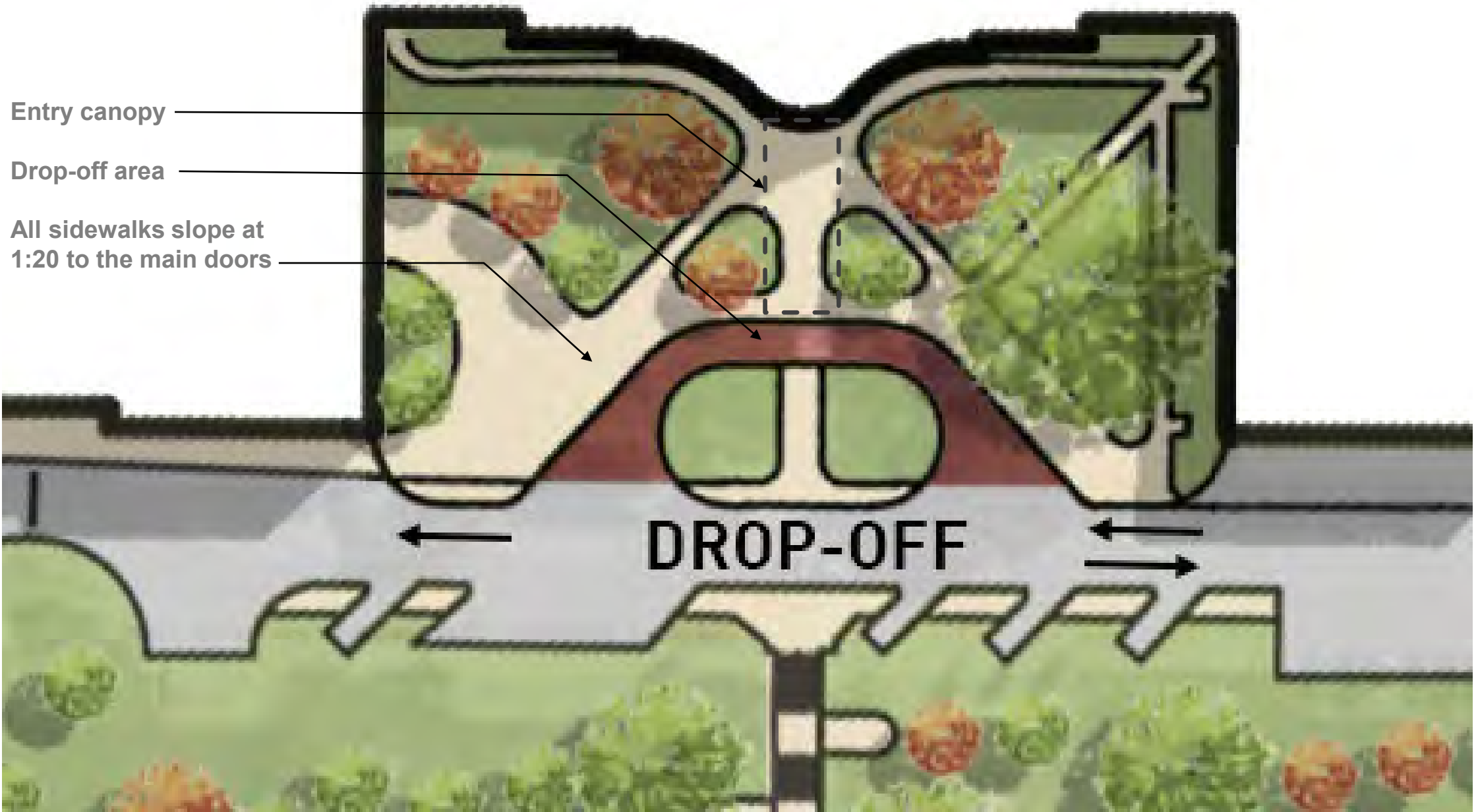

View 1 | Proposed South Entry Drop-off



View 3 | Proposed South Entry Drop-off



Site Plan I Strategies

1. South Entrance Drop-Off
2. Ludlow Quad with Drop-Off

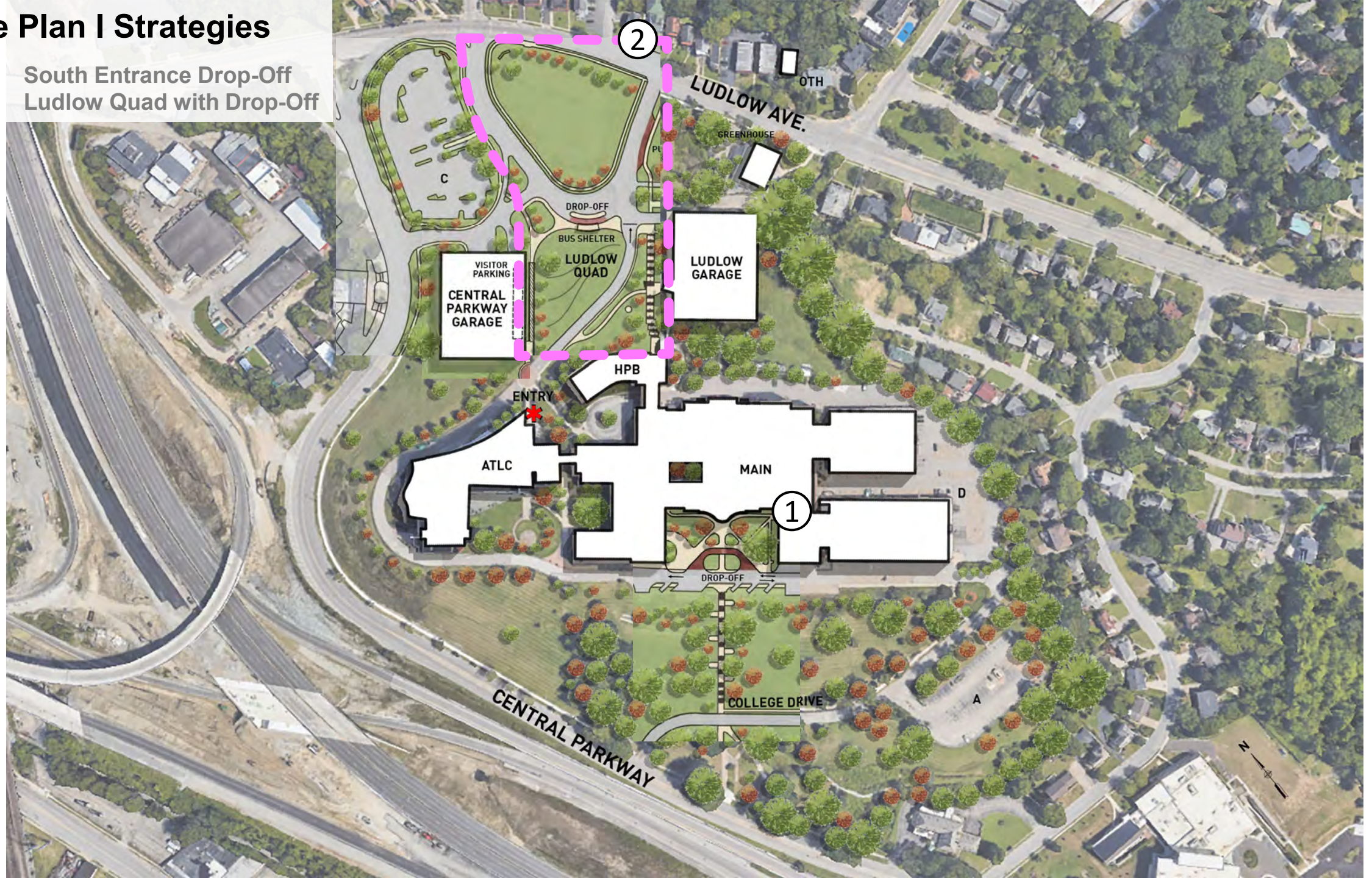

Site Plan I Proposed North Entry Drop-off

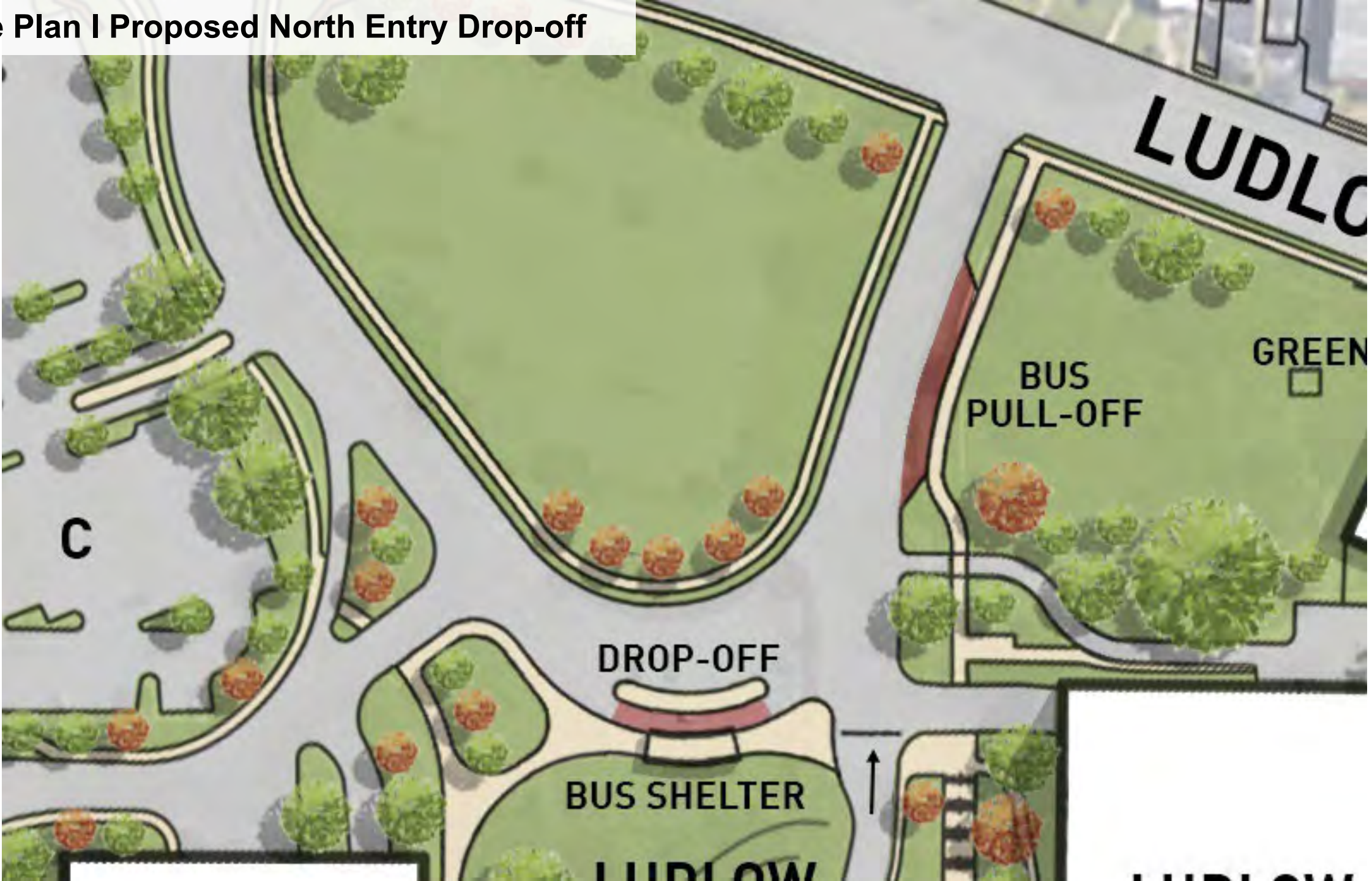

Precedent Images | Proposed North Entry Drop-off



Site Plan I Proposed

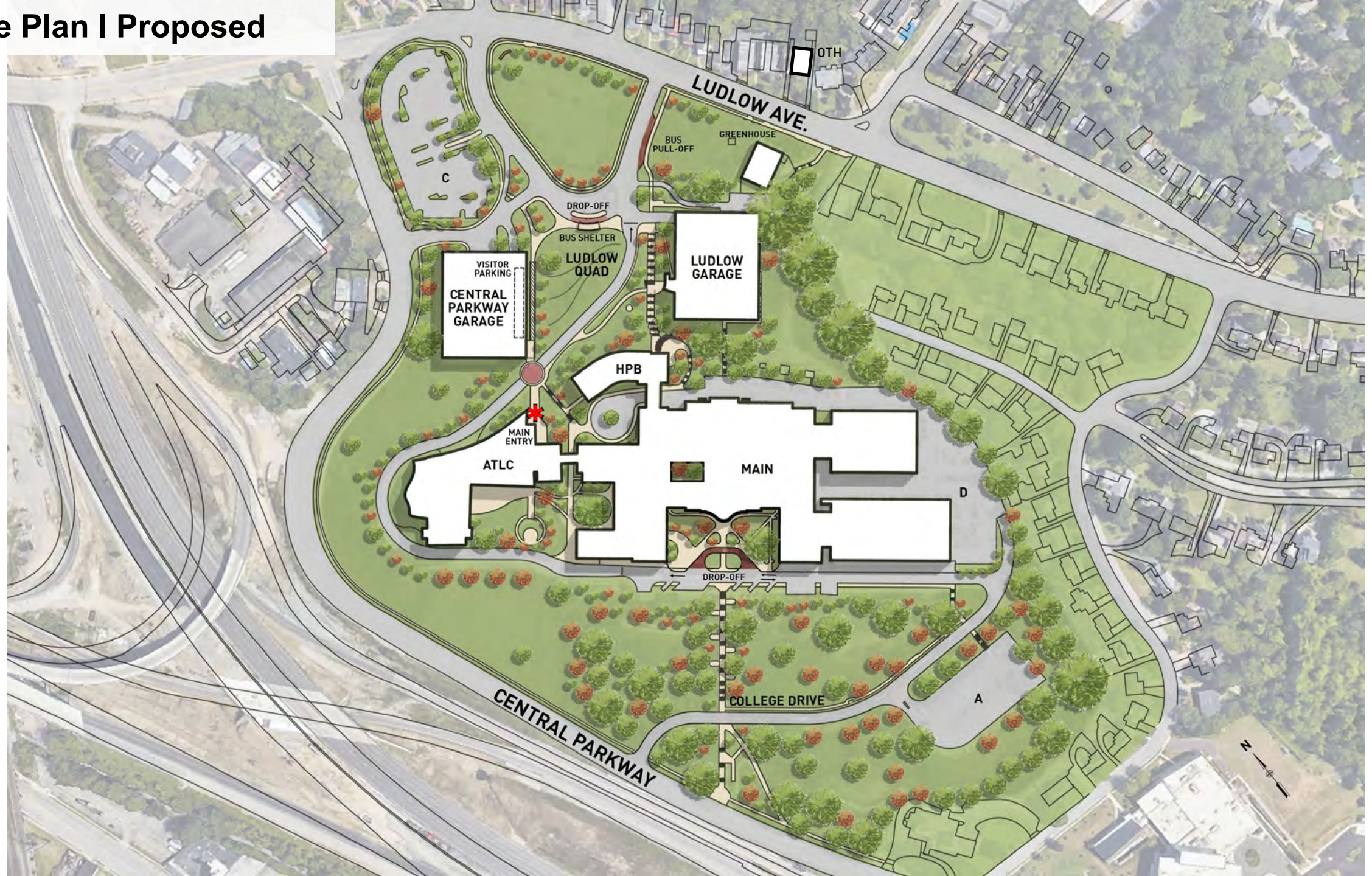

STUDENT COLLABORATION SPACES

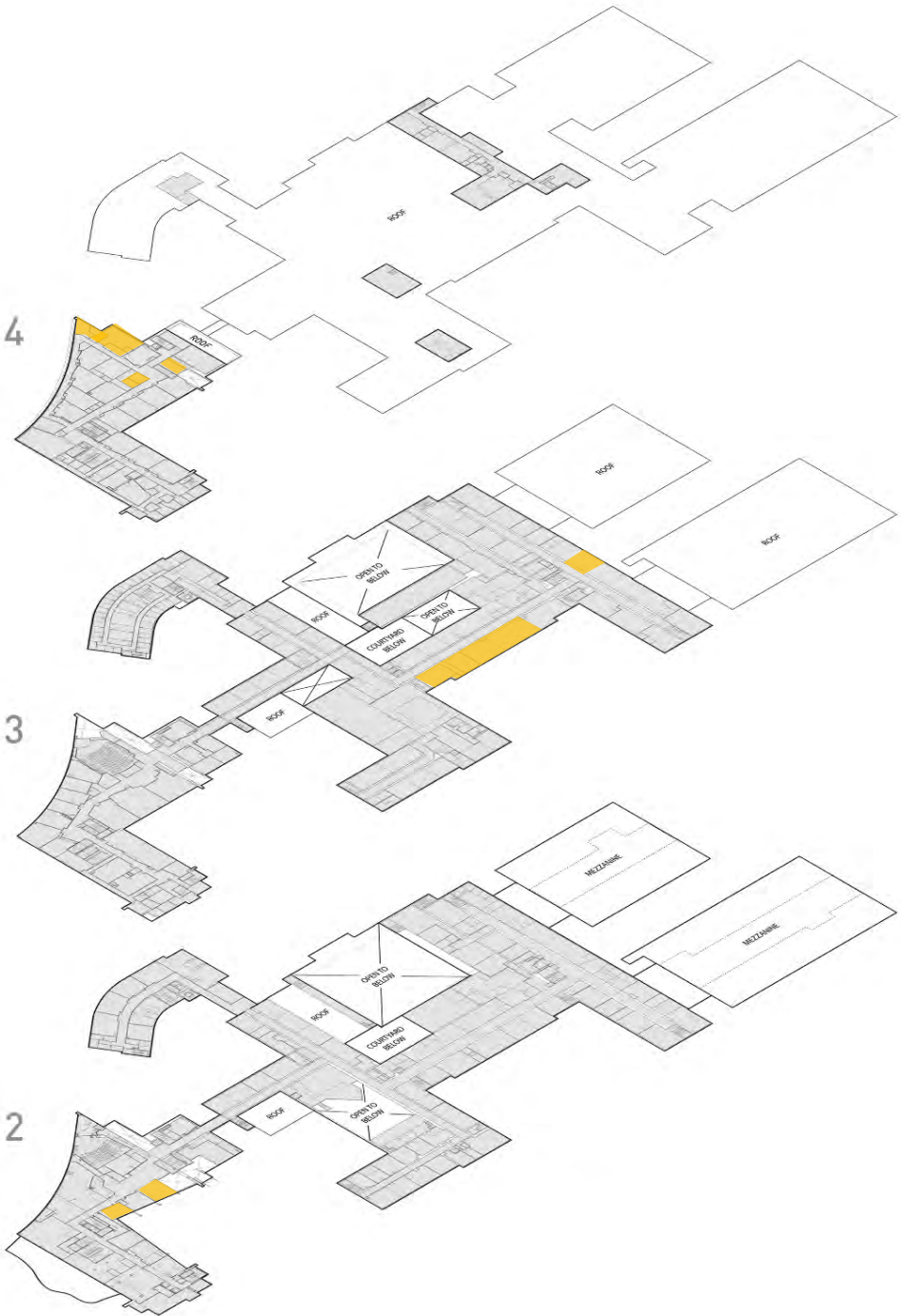
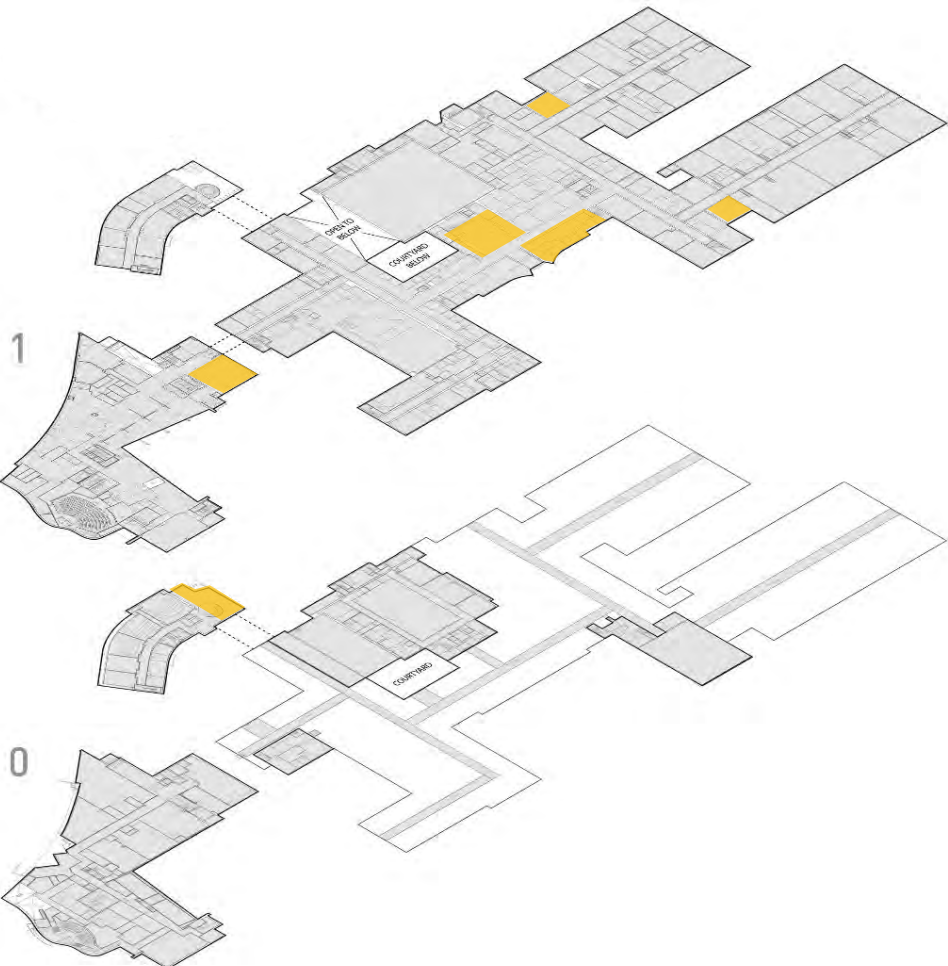

PRECEDENT IMAGES | STUDENT COLLABORATION SPACES



PROPOSED STUDENT RECREATION SPACE

- Business Technologies ■
- Engineering and IT ■
- Health and Public Safety ■
- Humanities and Sciences ■
- Classroom and Computer lab ■
- Student Life ■
- Vertical Circulation ■
- Building Support ■
- Administration ■
- Student Services ■
- Unused ■



Level 0

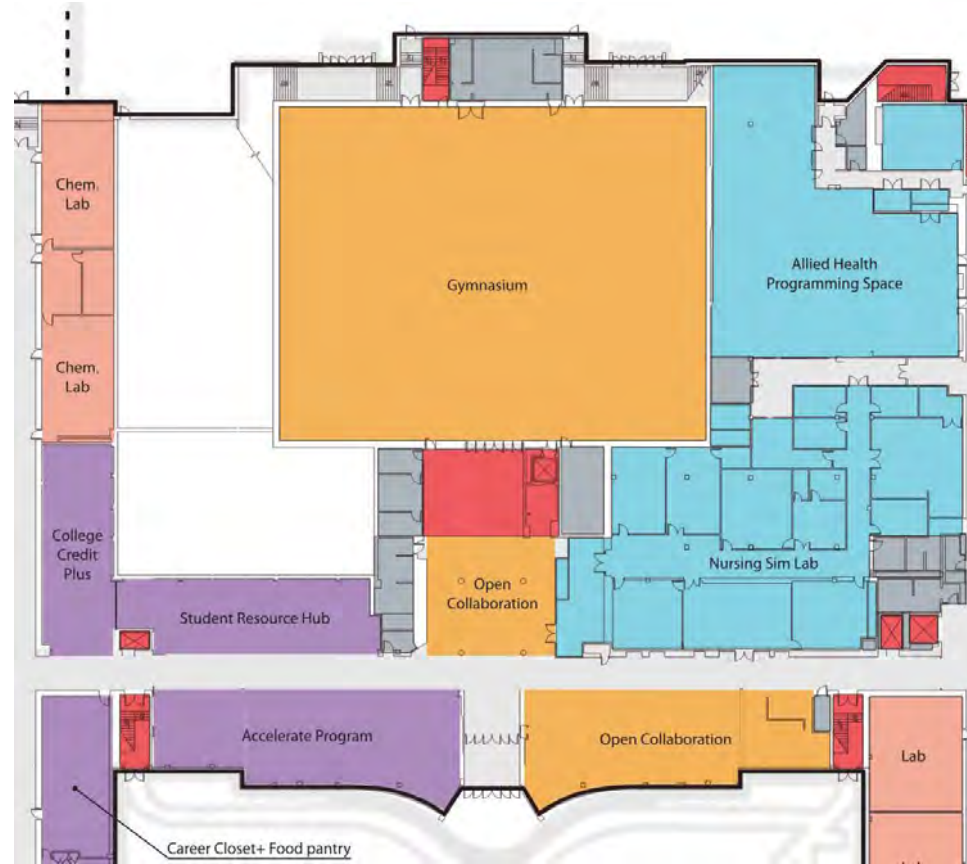

Level 1

GYM ENTRANCE | EXISTING



GYM ENTRANCE | FLOOR PLAN

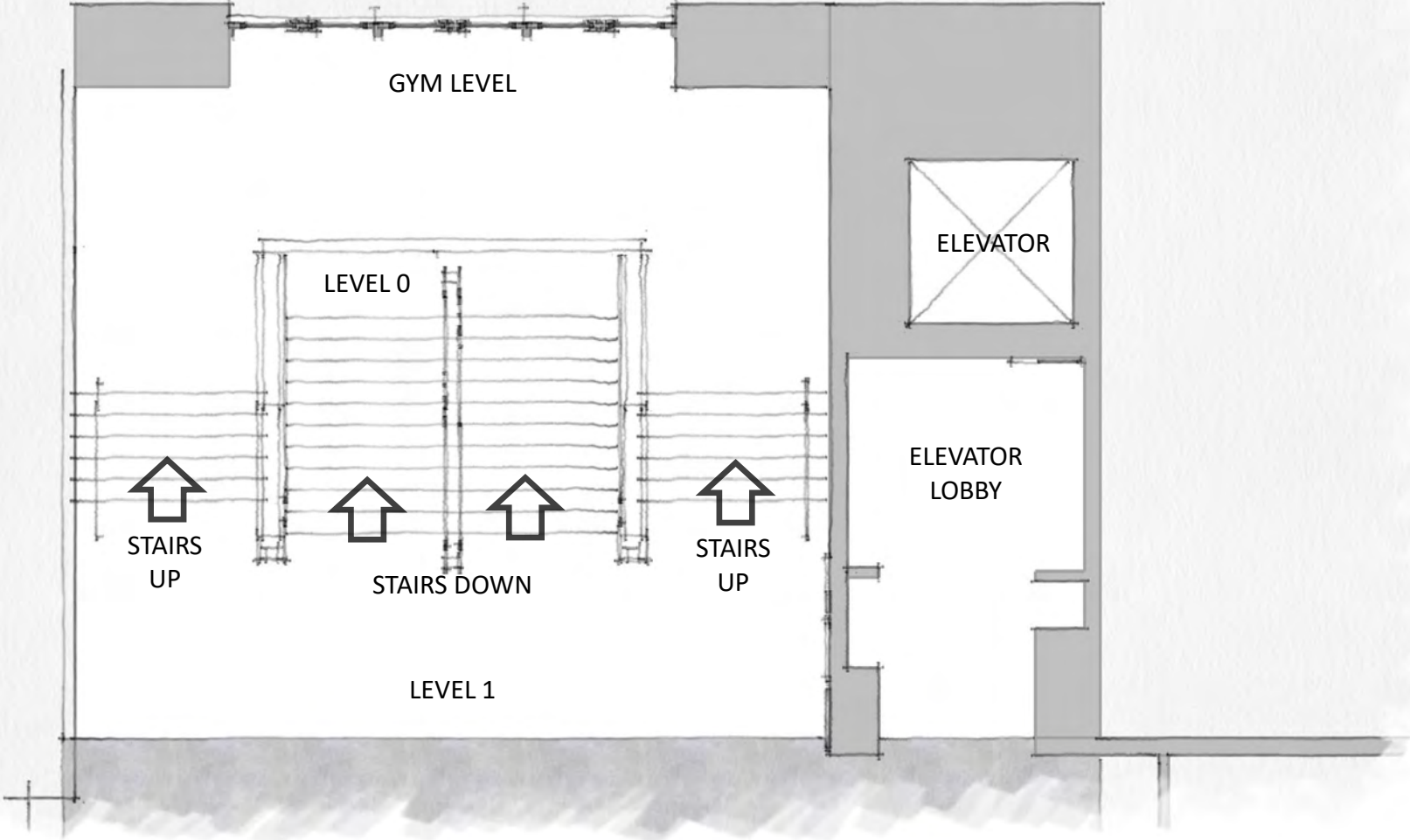

GYM ENTRANCE | PERSPECTIVE



E-SPORTS PRECEDENT IMAGES



STUDENT RECREATION SPACE PRECEDENT IMAGES

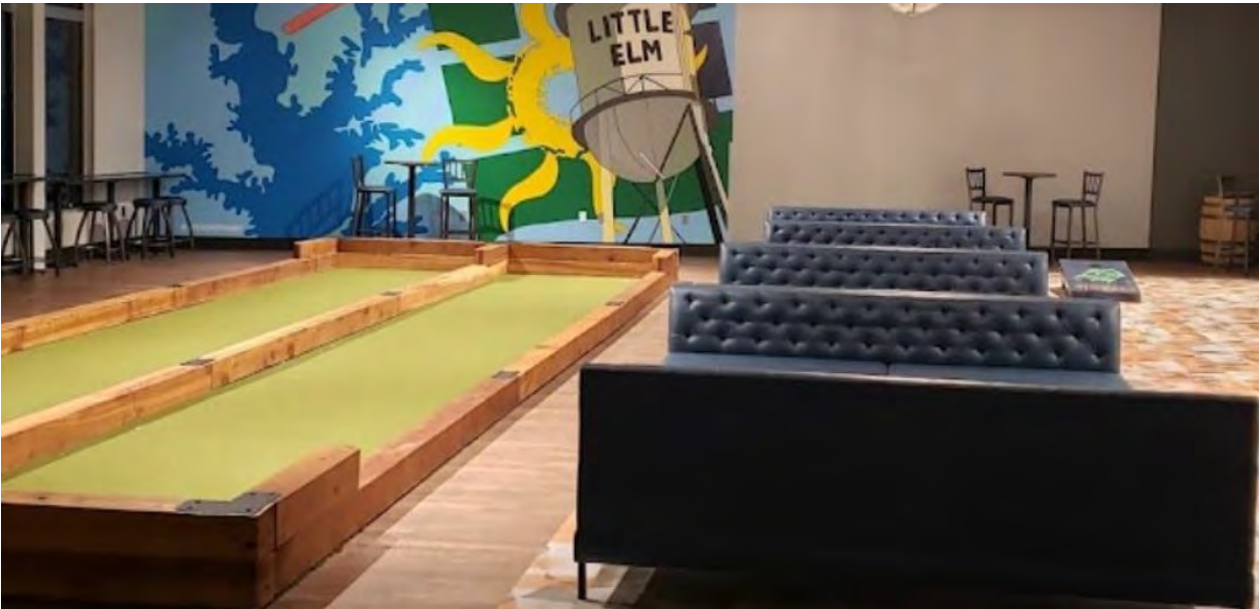

STUDENT RESOURCES

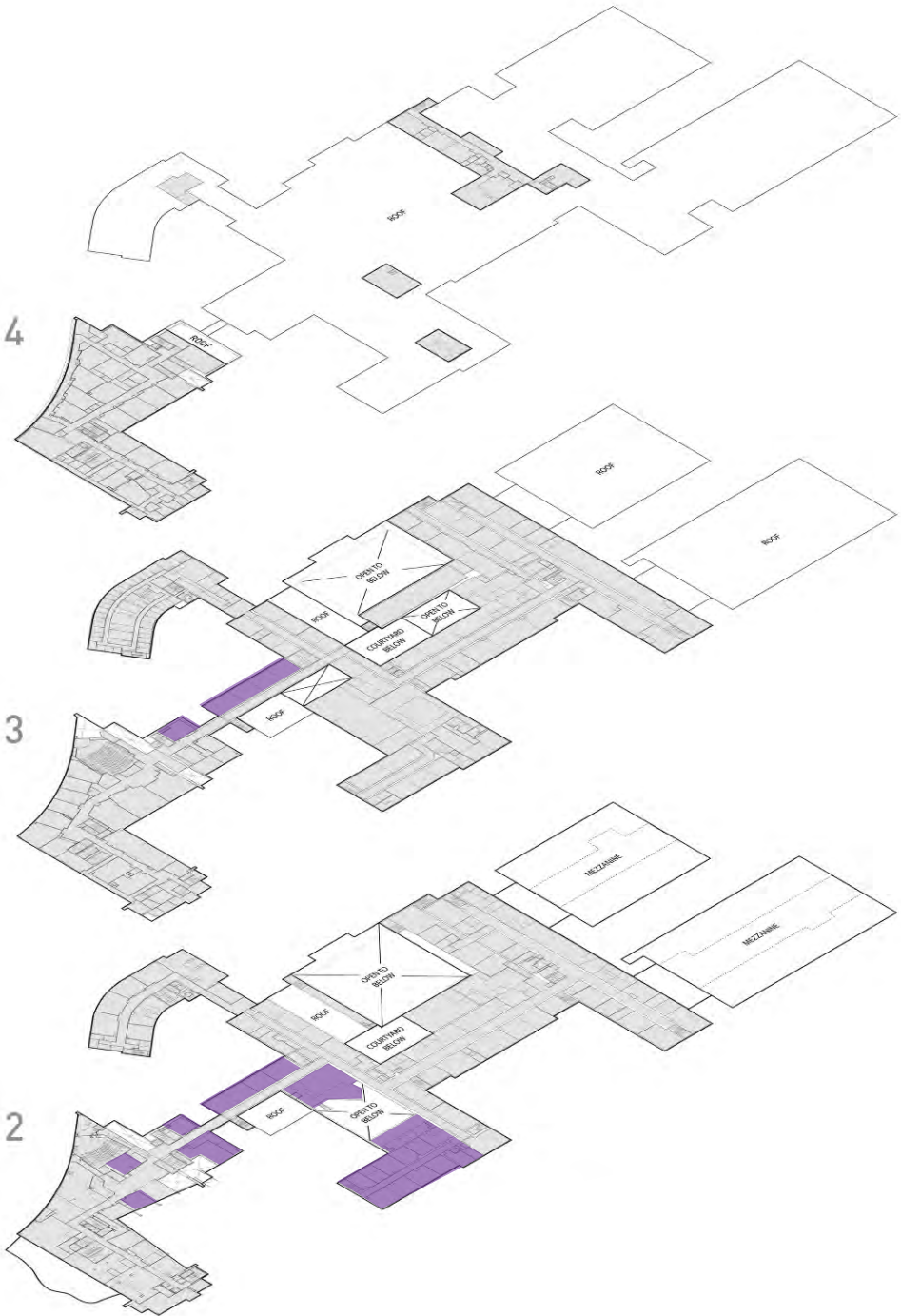
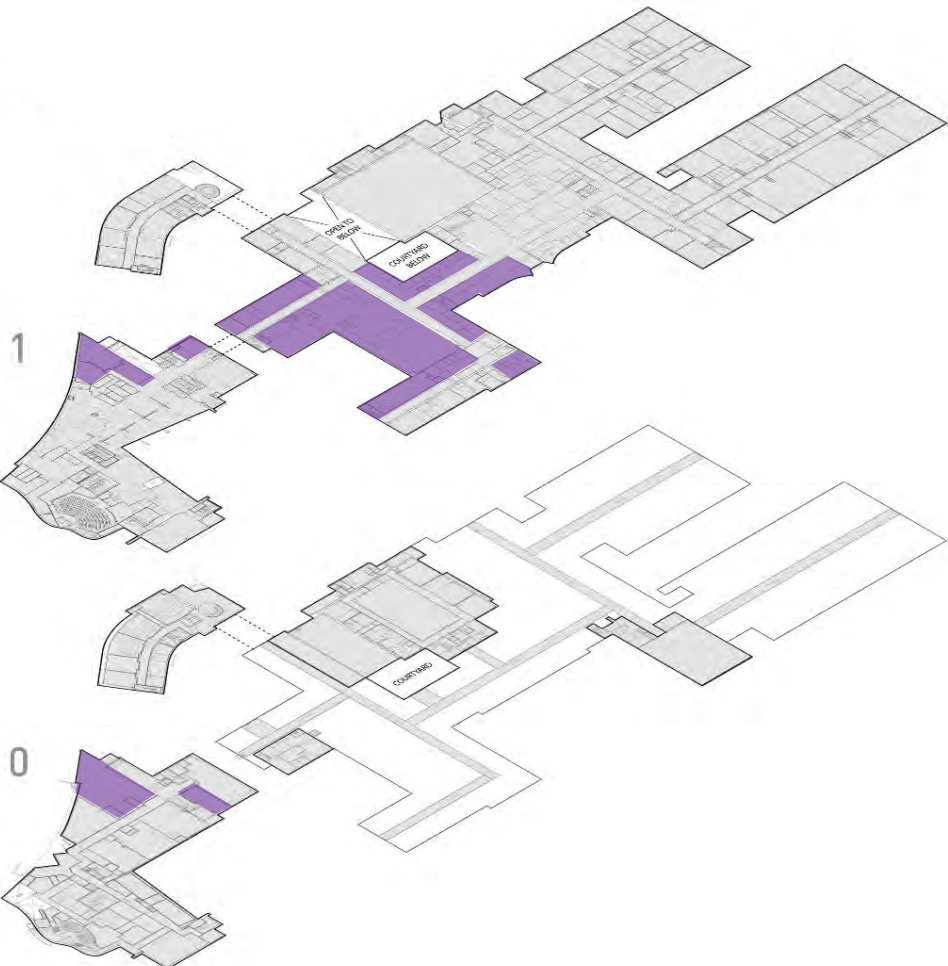

LEARNING CENTERS

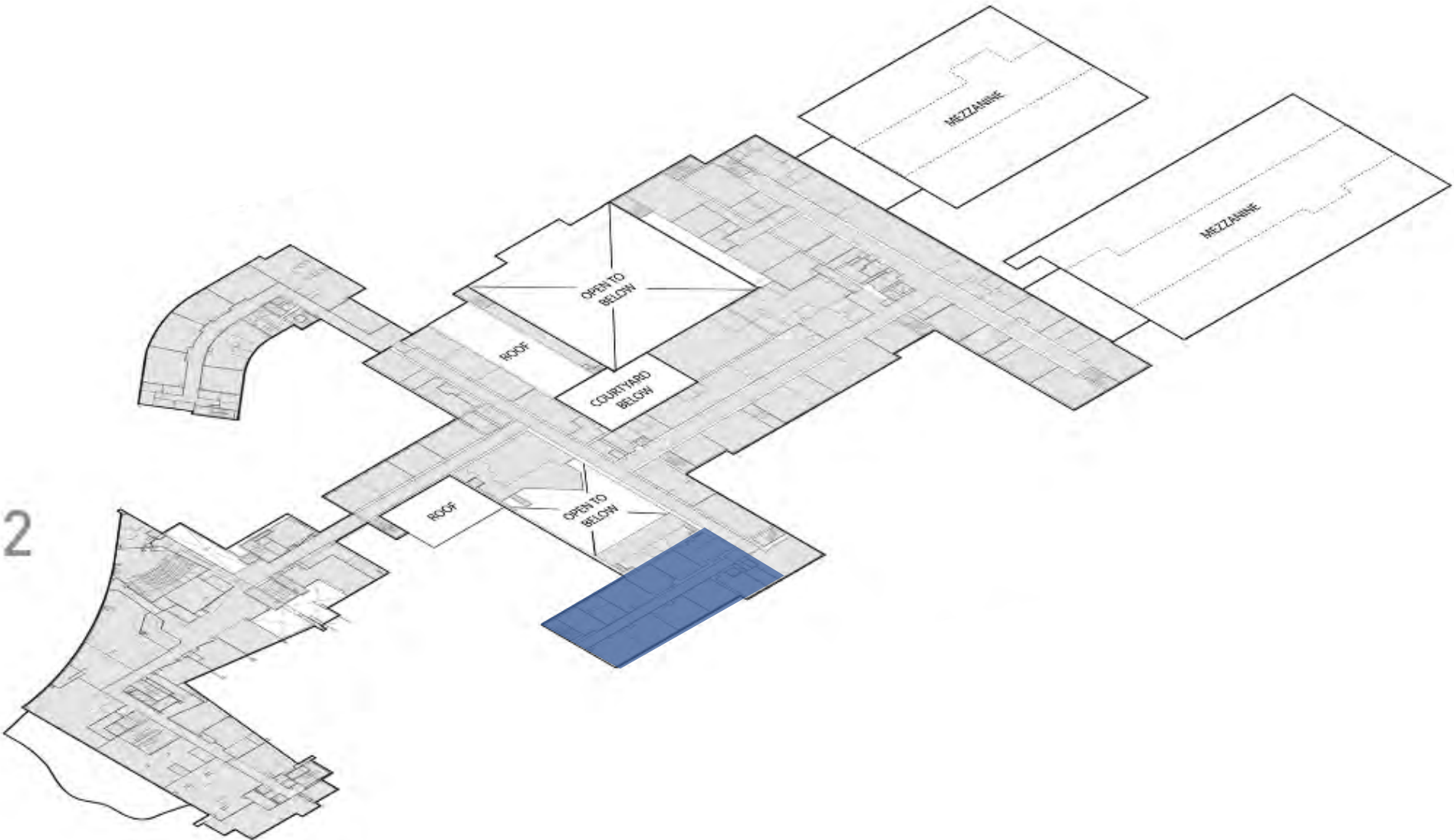

2



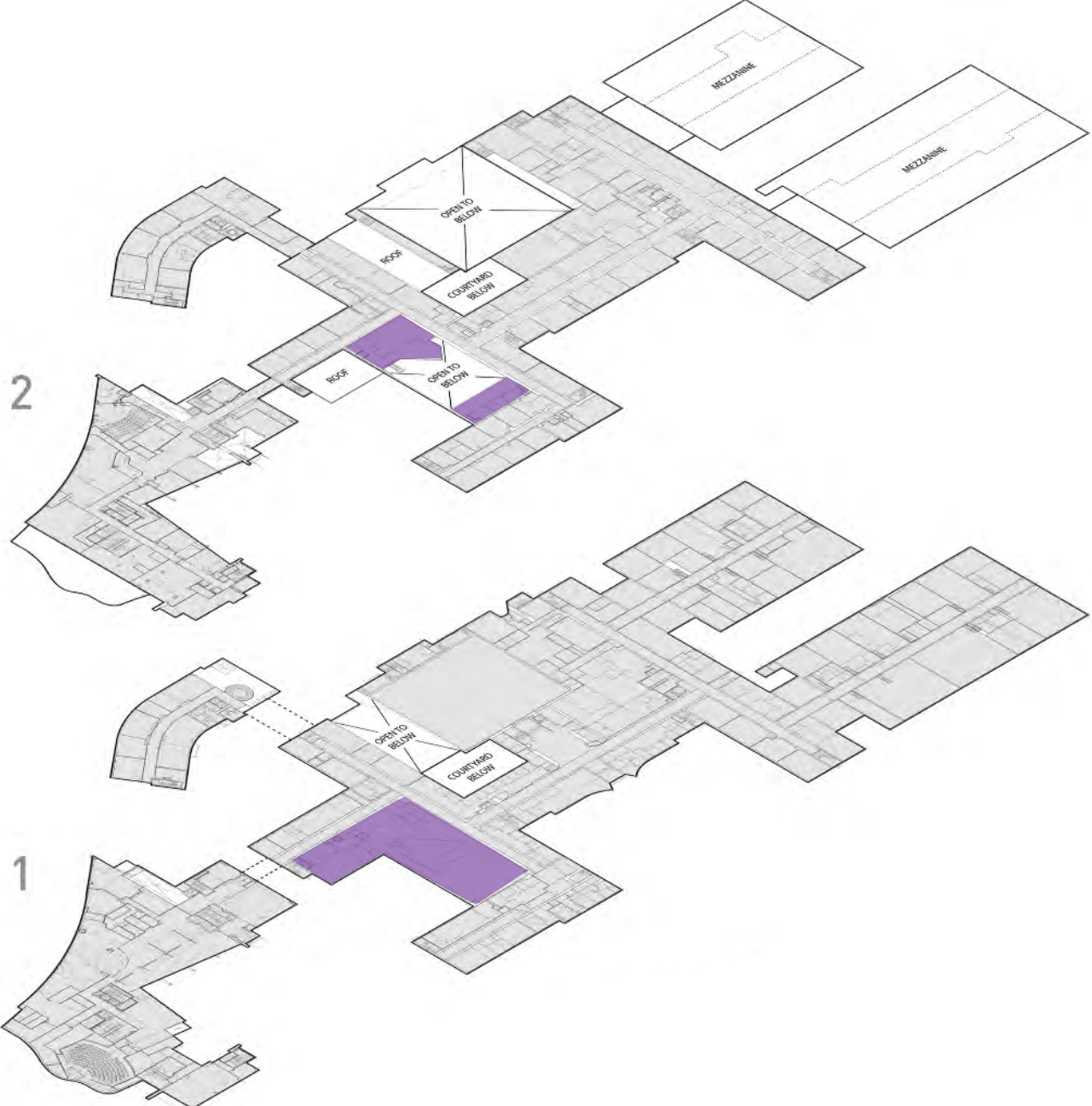





LIBRARY



LIBRARY PRECEDENT IMAGES

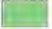

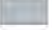
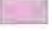
PROPOSED FLOOR PLANS

- Business Technologies 
- Engineering and IT 
- Health and Public Safety 
- Humanities and Sciences 
- Classroom and Computer lab 
- Student Life 
- Vertical Circulation 
- Building Support 
- Administration 
- Student Services 



Level 4

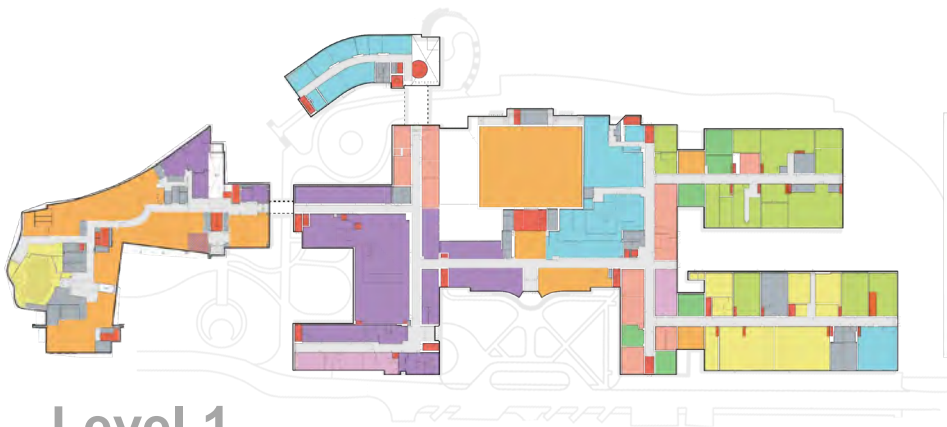

Level 1

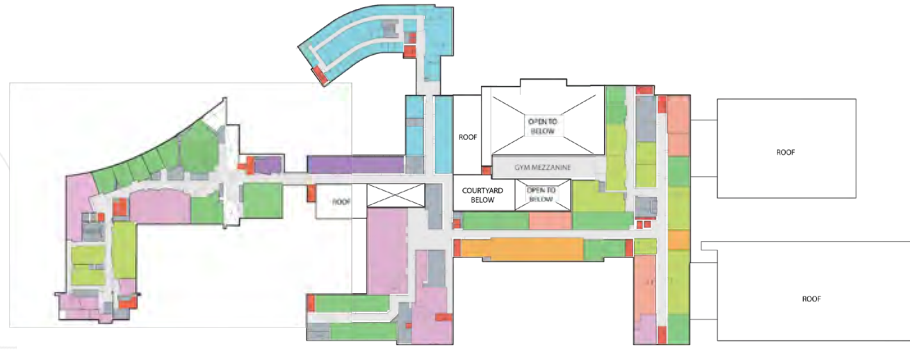

Level 3

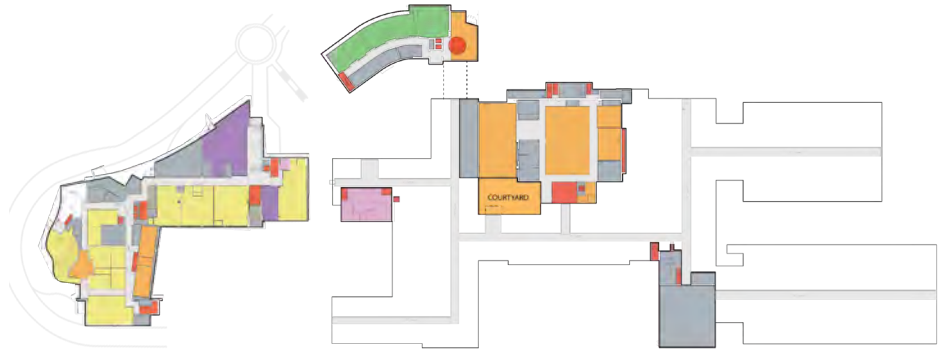

Level 0

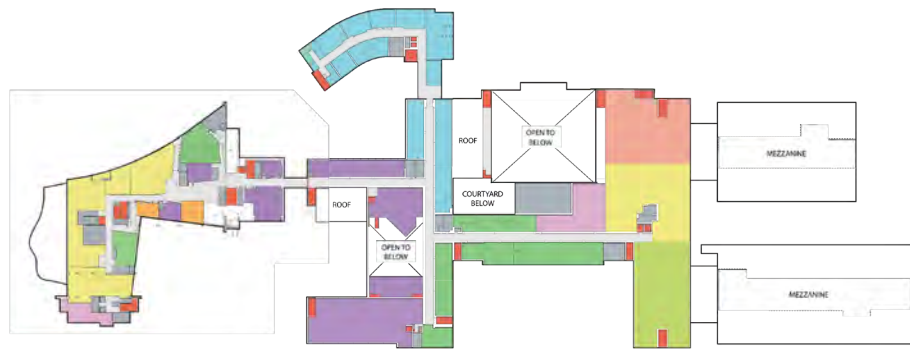

Level 2

BHDP